

# Sight Flow Indicators (straight line) with Spinner

with **flanged** connection acc. to **ANSI - 150 / 300 lbs**



**Cast Iron** GG 25 (EN-GJL-250) max. 150 lbs  
**Cast Steel** GS-C 25 (1.0619 / GP240GH)  
**Stainless Steel** WN 1.4408

**Bauform 880-A-RK**  
**Bauform 880-A-RP**

## Application:

The flow indicators are used for optical control of fluids and gases, for horizontal and vertical pipe lines.

## Installation:

Optional. Take care of flow direction

## Operating conditions:

Working pressure: 16 bar by 150 lbs  
 40 bar by 300 lbs  
 Working temperature: 120°C or 260°C

## Certificate: (Option)

Acc. to EN 10204-2.2 or 3.1

## Options:

- with - Flap
- Heating jacket
- Sight glass light - fitting

## Materials:

Body	<b>GG 25</b>	<b>GS-C 25</b>	<b>1.4408</b>
Covers	GG 25 / S235JRG2	GS-C 25 / S235JRG2	1.4408 / 1.4301
Screws	4.6 / 5.6 gal.		A4-70
Sight glass	Borosilicate glass DIN 7080 Soda-lime glass DIN 8902 (150°C)		
Gaskets	Graphite, ( or other materials )		
Spinner	Plastic up to 120°C; <b>Bauform 880-A-RK</b> PTFE up to 260°C; <b>Bauform 880-A-RP</b>		

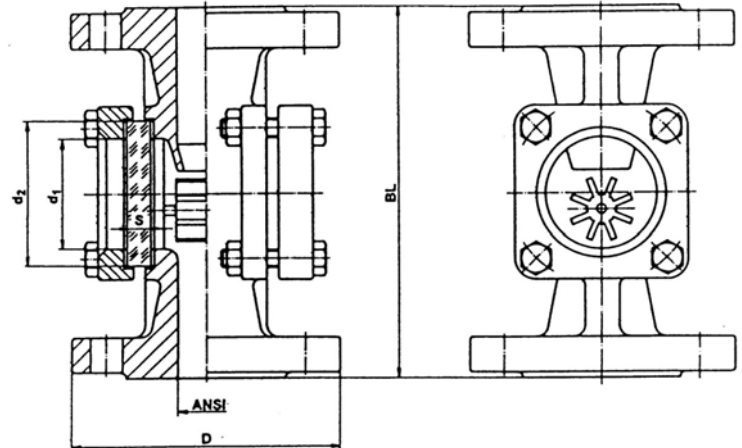

## Ordering example:

Sight Flow Indicators with Spinner; Bauform 880-A-RP  
 GS-C 25, PTFE-Spinner  
 Borosilicate glass DIN 7080-16 bar  
 ANSI 2"; 150 lbs



## Dimensions:

ANSI	D		BL (DIN F1)	d <sub>1</sub>	Glass plate		
	150 lbs	300 lbs			d <sub>2</sub>	S	
						16 bar	40 bar
1/2"	89	95,2	130	32	45	10	10
3/4"	98	117,3	150	32	45	10	10
1"	108	123,8	160	48	63	10	15
1 1/4"	118	133,4	180	48	63 ***	10	15
1 1/2"	127	155,6	200	65	80	12	20
2"	152	165,1	230	80	100	15	25
2 1/2"	178	190,5	290	80	100	15	25
3"	191	209,6	310	100	125	20	30
4"	228 *	254,0	350	125	150	25	35
5"	254 *	279,4	400	150	175	25	a.A.
6"	279	317,5	480	175	200	30 **	a.A.
8"	343 *	381,0	600	175	200	30 **	a.A.
10"	406 *		730	175	200	30 **	a.A.

\* by cast iron different diameter by D acc. to DIN

\*\* 16 bar only with borosilicate glass possible

\*\*\* by cast iron glasses Ø 80x12mm

Modifications reserved



AVEMAR cz s.r.o., Lihovarská 10, 716 03 Ostrava - Radvanice  
 Tel.: +420 596 232 996, 596 232 997, Fax: +420 596 232 998  
 E-mail: avemar@avemar.cz, web: www.avemar.cz