

Sight Glass Fittings Obround

to be *welded* directly to tank



Bauform 225

Application:

To show surface of a liquid, for insertion into attachment to tanks, bessels and silos.

Operating conditions:

Temperature : 100°C or 243°C
Pressure: 3 / 6 / 25 bar

Materials:

Body: WN 1.4571 / 1.4435 / RSt 37-2 / H II
Cover: WN 1.4571 / 1.4435 / RSt 37-2 / H II
Srews: DIN 912, A4-70 or 8.8 vz
Sight glass: Borosilicate glass acc. to DIN 7081
Soda lime glass acc. to DIN 8903
Gaskets: Asbestos free
(other materials are available on request)

Mounting instruction:

After welding please examine if sealing aera is plane. Otherwise re-machining is necessary.

Example for an order:

Sight glass fittings, obround Bauform 225
Body WN 1.4571
Cover RSt 37-2
Borosilicate glass – 3 bar
410 x 120 mm
Quantity

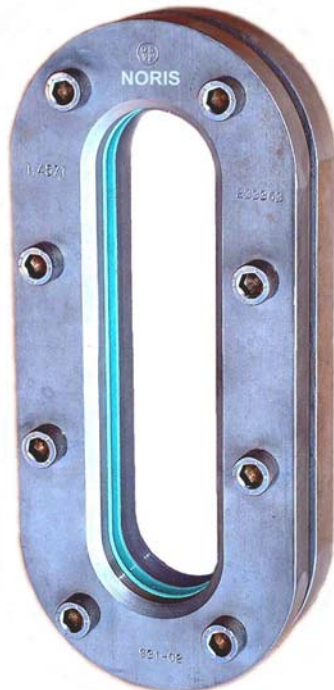

Modifications reserved

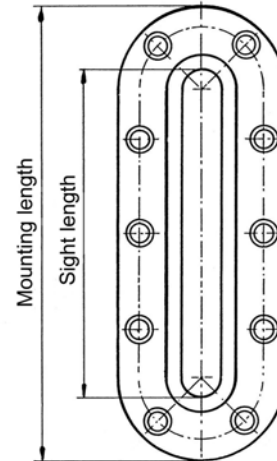
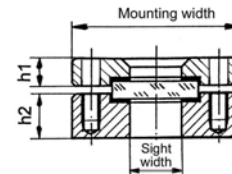

Pressure 3 bar, Visual 50 mm

Mounting dim.		Sight dim.		Strength	
Length	Width	Length	Width	h1	h2
270	120	200	50	15	25
340	120	270	50	15	25
410	120	340	50	15	25
480	120	410	50	15	25
550	120	480	50	15	25
620	120	550	50	15	25
690	120	620	50	15	25
760	120	690	50	15	25

Pressure 6 bar, Visual 30 mm

Mounting dim.		Sight dim.		Strength	
Length	Width	Length	Width	h1	h2
250	100	180	30	15	25
310	100	240	30	15	25
370	100	300	30	15	25
430	100	360	30	15	25
490	100	420	30	15	25
550	100	480	30	15	25
610	100	540	30	15	25
670	100	600	30	15	25

Pressure 25 bar, Visual 20 mm

Mounting dim.		Sight dim.		Strength	
Length	Width	Length	Width	h1	h2
176	70	126	20	20	25
226	70	176	20	20	25
256	70	206	20	20	25
316	70	266	20	20	25
376	70	326	20	20	25
436	70	386	20	20	25
496	70	446	20	20	25
536	70	486	20	20	25