

Sight Flow Indicators (straight line)

with *butt weld ends* (S)

welding design



Bauform 108-S

Application:

Sight Flow Indicators are used for optical control and the observation of filling and current in pipelines.

Operating conditions:

Working pressure : 16 bar

Installation:

Optional. Take care of flow direction

Standard Materials:

| | 108-S-VV | 108-S-VS | 108-S-St |
|----------------|--|---------------|----------|
| Body : | 1.4435/1.4404 | 1.4435/1.4404 | RSt 37-2 |
| Covers : | Stainless Steel | Steel | Steel |
| Screws : | A4 - 70 | Steel | Steel |
| Sight glasses: | Borosilicate glass acc. to DIN 7080 (max. 280°C) Soda lime glass acc. to DIN 8902 (max 150°C) | | |
| Gasket : | Graphite (other materials are available on request) | | |

Options:

Other materials
Flanges connection
Sight glass light-fitting
Spinner or Flap

Ordering example:

Sight flow indicators with butt weld ends
Bauform 108-S-VS
body stainless steel, cover steel
borosilicate glass 16 bar
DN 50 / 60,3

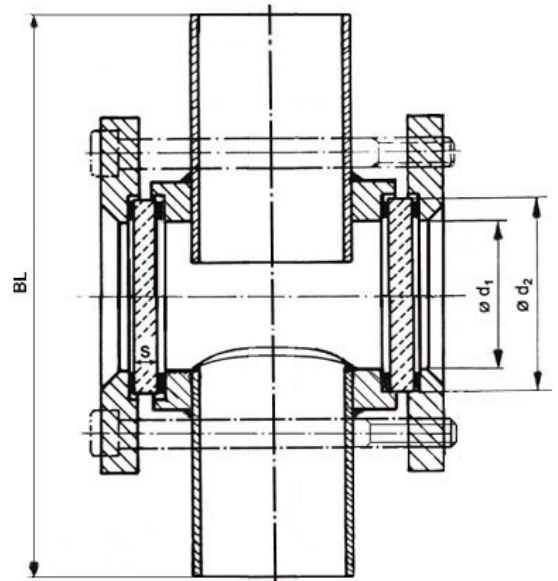

Dimensions:

| DN | BL | Glass plate | | | Screws | Weight ca. Kg |
|-----------|-----|------------------|------------------|----|--------|------------------|
| | | ø d ₁ | ø d ₂ | S | | |
| 15 / 21,3 | 124 | 32 | 45 | 10 | M 8 | 1,8 |
| 20 / 26,9 | 144 | 48 | 63 | 10 | M 10 | 2,7 |
| 25 / 33,7 | 154 | 48 | 63 | 10 | M 10 | 2,8 |
| 32 / 42,4 | 174 | 65 | 80 | 12 | M 10 | 4,6 |
| 40 / 48,3 | 194 | 65 | 80 | 12 | M 12 | 4,8 |
| 50 / 60,3 | 224 | 80 | 100 | 15 | M 12 | 6,5 |
| 65 / 76,1 | 284 | 80 | 100 | 15 | M 12 | 7,6 |
| 80 / 88,9 | 304 | 100 | 125 | 20 | M 12 | 11,8 |

Further sizes on Bauform 112-S

Modification reserved