

Globe valve type WA10

Application and function

As shutoff valve in pipes, e.g. connection pipe between steam boiler and water level limiter.

The area of application comprises the entire product range of magnetic level gauges and float switches.

Technical basic equipment

- Valve form: straight through
- Process connection: Flange or welding end according to DIN
- Valve housing: C-steel
- Inner parts of valve: stainless steel

Available (optional) versions

- Other process connection on request

Technical data

Allowable pressure	PS [bar]	10	32	50	80	100
Allowable temperature	TS [° C]	195	239	265	296	312

Installation information: Valve spindle must be in horizontale position
Arrow on valve body (housing) must point towards standpipe

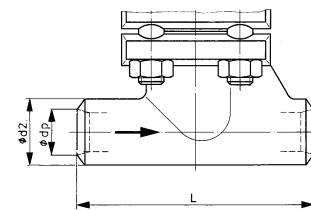
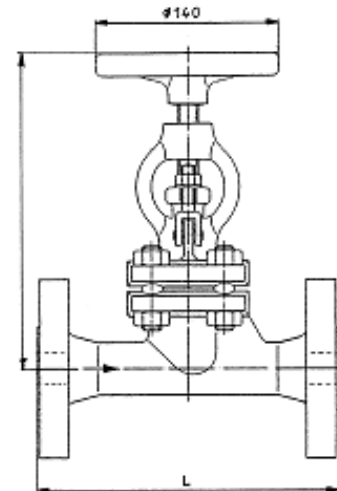

PS [bar]	Dimension M		Contact face Form	Dimension [mm]		PS [bar]	Welding end					Dimension [mm]	
	DN	DIN		DIN	L		H	DN	DIN	$\varnothing d1$	$\varnothing d2$	$\varnothing d3$	L
13	20	2633	2526-C	150	220	13	20	3239-2	22	28	26,9	150	220
	25			28,5					34	33,7	160		
32	20	2635		150		32	20	25	3239-2	22	28	26,9	150
	25			160						28,5	34	33,7	160
80		2637	2526-E	230	80	80	3239-2	27					
100		2638			100				100				

